



From: ALLOY CASTINGS CO., INC.
Quality Aluminum Castings Since 1948

151 West Union Street • East Bridgewater, MA 02333
 Telephone: (508) 378-2541 • FAX: (508) 378-1240
 www.alloycastings.com

Westport Style Decorative Pole

LAMP POST SPECIFICATIONS

- Style:** Westport
Height: 8', 10' and 12' ±
Base: 13" ± Square Base
Tenon: 4 3/4" x 2 7/8" Diameter
Optional Tenon Heights and Diameters Available
- Material:** Heavy Wall Cast - Aluminum 356 Alloy
Shaft: 6063 Aluminum Shaft - 188 Wall Thickness
Finish: Primed and Finish Painted to your Specifications
- Access Door:** Located in Base
Anchor Bolts: (4) 3/4" x 24" plus 3" Hook including 1 lock washer 2 flat washers and two nuts. Fully Galvanized.
Bolt Projection: 3" Above Foundation
Bolt Circle: 14" ± Diameter
- Features:** Variety of Heights Are Available Using Spun Aluminum Shafts.
- Luminaire Options:** There is a wide variety of luminaires available. Consult factory for options.
- Finish Options:** A wide variety of colors are available using the finest quality paints. Thermostat powder coating is available upon request.

Accessory Options: Ladder rest, decorative brackets available.

ANCHOR BOLT
 DETAIL

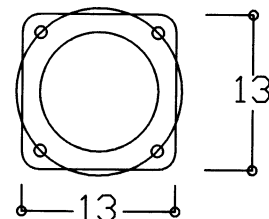

14" DIA. ± BOLT CIRCLE FOR
 3/4" ANCHOR BOLTS

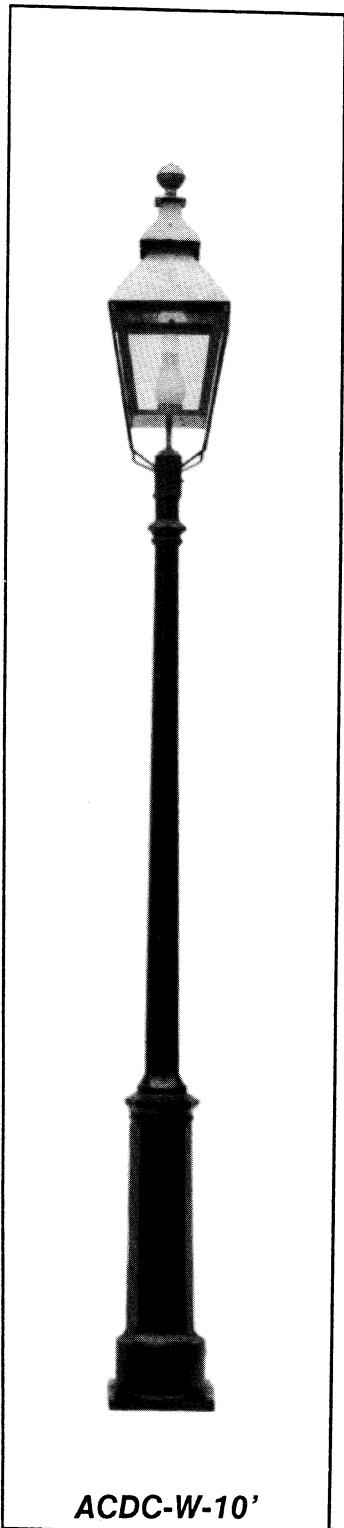

ACDC-W-10'

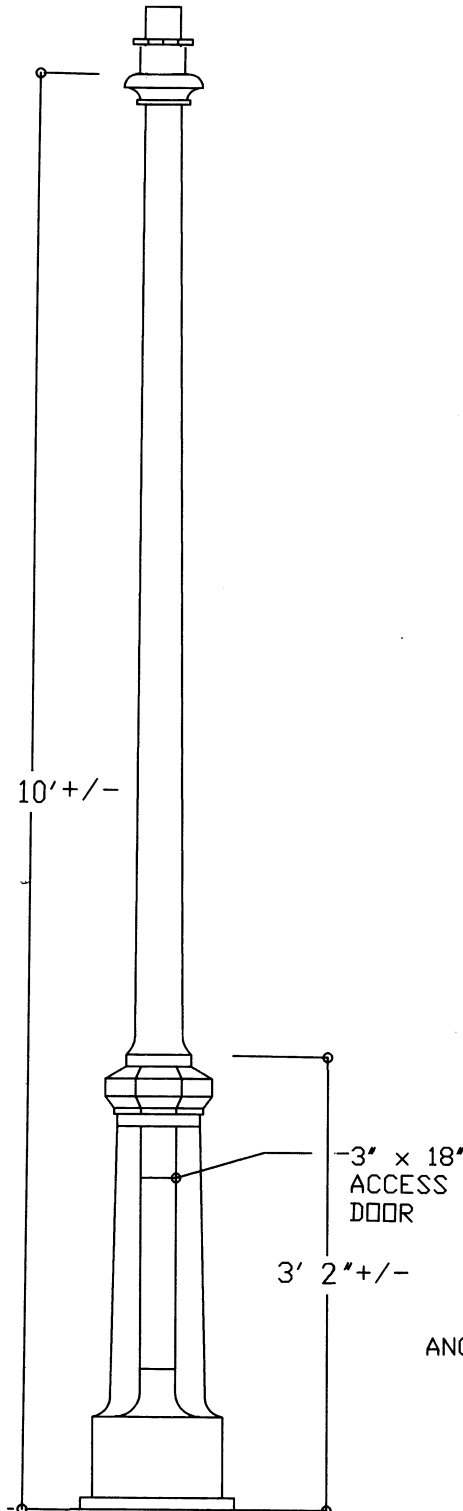

SCALE: 3/4" = 1 FOOT